

CH 10 gPV - Fuse-links

General characteristics

UL file: E347771

Rated voltage	1000V d.c. L/R=2ms
Breaking capacity	30kA d.c.
Standards	IEC 60269-6 ed 1.0 (2010-9)
Application	For protection of photovoltaic modules.



lead-free



RoHS
2002/95/EC



Standard
Contacts



Type SU
Contacts

CH 10 gPV

Size	I_n [A]	Code No. "standard contacts"	Code No. "type SU contacts"	Pre-arcing Joule integral [A ² s] L/R=2ms	Operating Joule integral [A ² s] L/R=2ms	Power dissipation [0,7 x I _n] ² P _d [W]	Power dissipation [I _n] ² P _d [W]	Weight [g]	Packaging [pcs]
10 x 38	1	002625138	002625129	0,8	2,5	0,4	1	10/12	10/500 SU:10/380
	2	002625101	002625115	1,3	3,5	0,52	1,25		
	3	002625100	002625113	2,6	7,5	0,55	1,3		
	3,5	002625135	002625127	3	9,5	0,48	1,16		
	4	002625102	002625116	4	13	0,52	1,25		
	5	002625111	002625124	7,4	23	0,63	1,49		
	6	002625103	002625117	10	45	0,73	1,65		
	7	002625110	002625114	13	57	0,79	1,92		
	8	002625104	002625118	17	62	0,84	2		
	10	002625105	002625119	21	88	0,97	2,3		
	12	002625106	002625120	28	110	0,95	2,2		
	13	002625137	002625128	30	160	1	2,3		
	14	002625136	002625126	31	180	1,1	2,5		
	15	002625112	002625125	33	260	1	2,4		
	16	002625107	002625121	35	270	1,1	2,6		
	20	002625108	002625122	50	430	1,3	3		
	25*	002625109	002625123	75	620	1,6	4		

* 900V d.c.

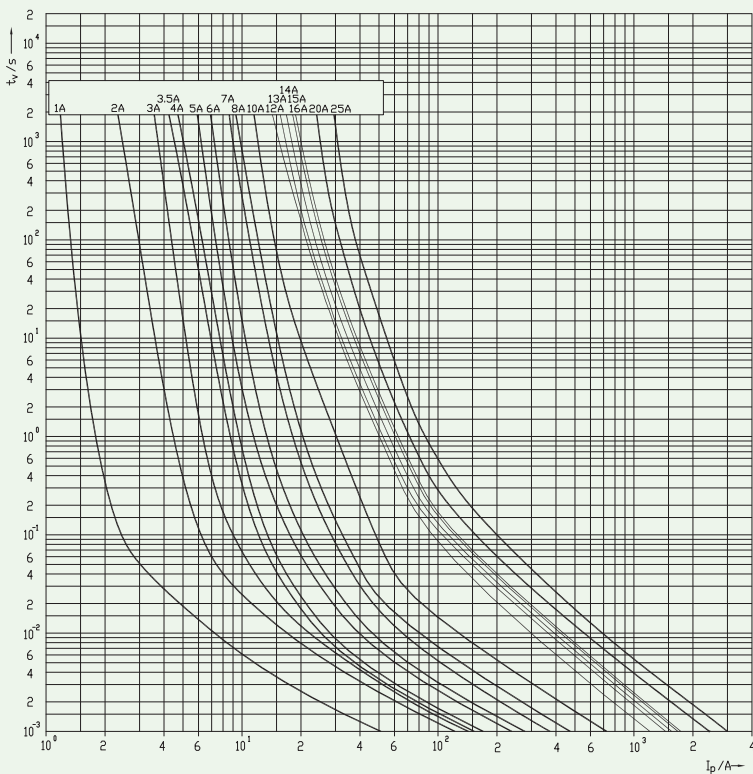

CH 10 gPV I/t characteristics

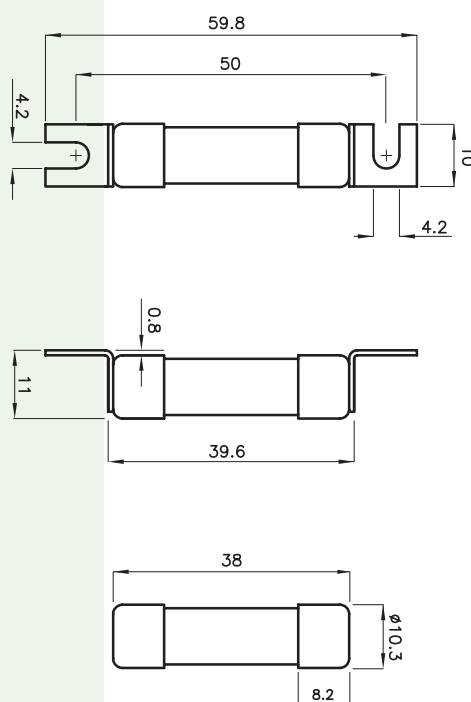

Green protect - DC